



SPORTS

3543



4224109

3540



3541



3542



3543





3540 Puck Passer



3541 Slap Shot



3542 Flip Shot



3543 Slammer Goalie



3544 Game Set



3545 Puck Feeder



1

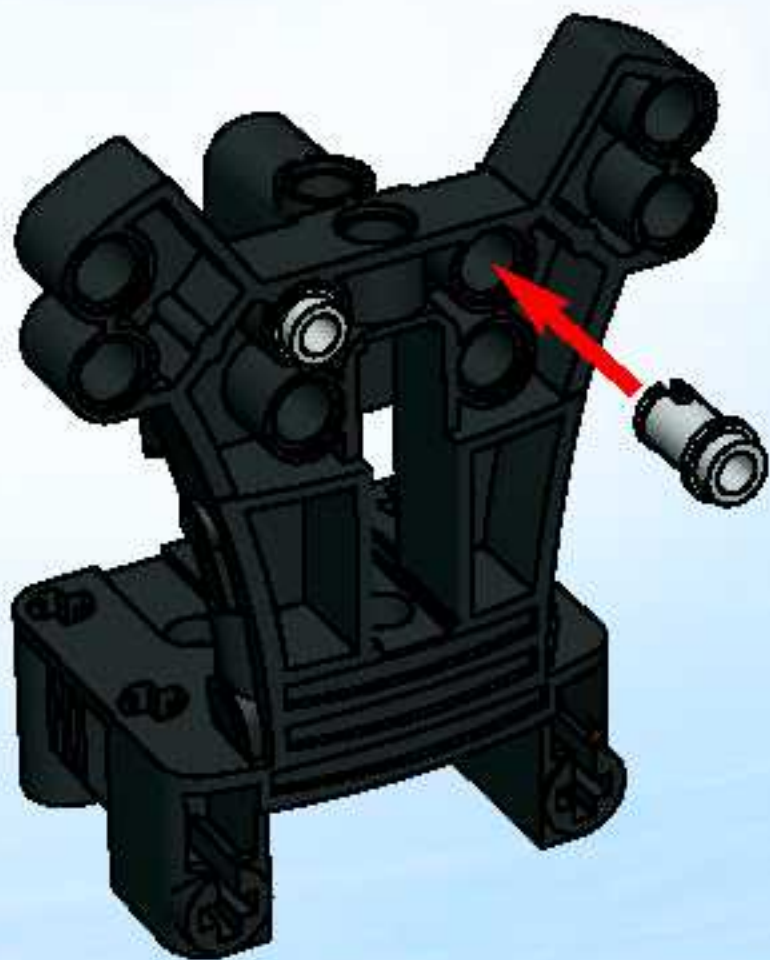

2

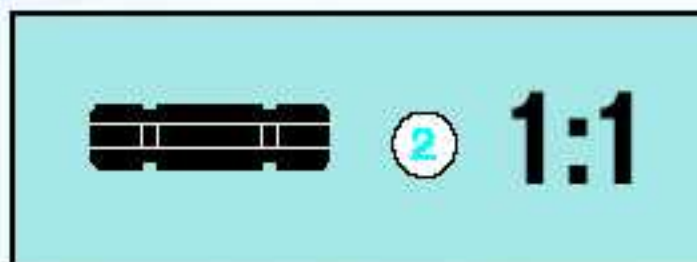
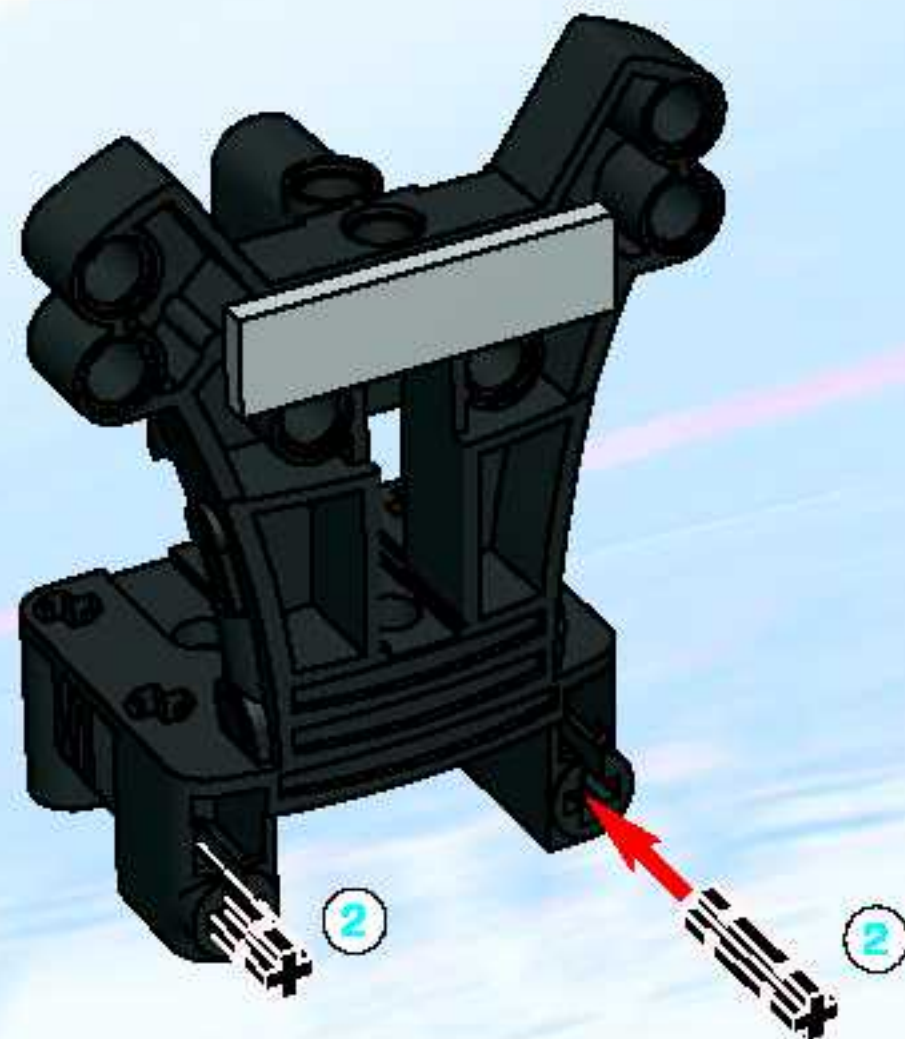

3

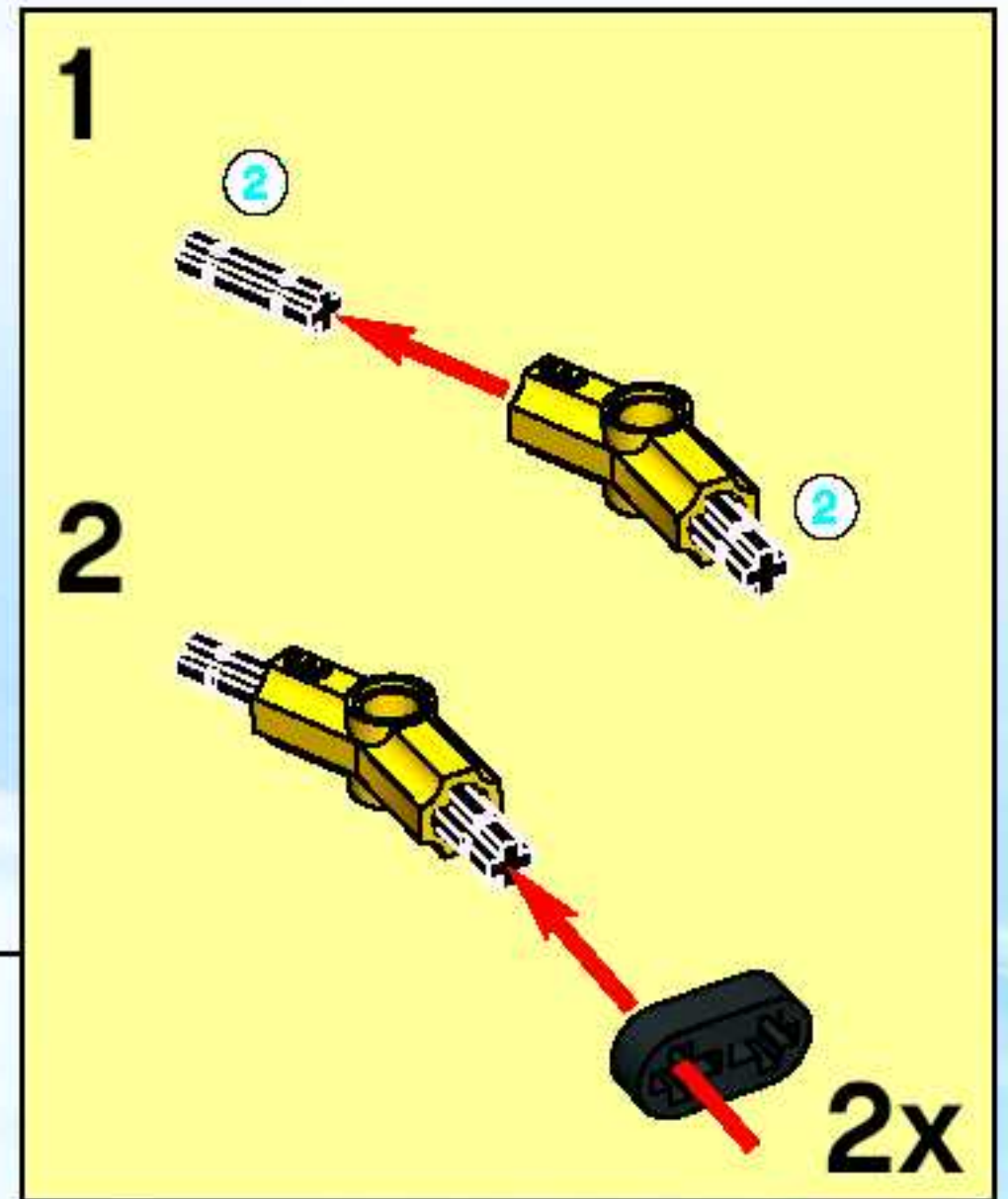
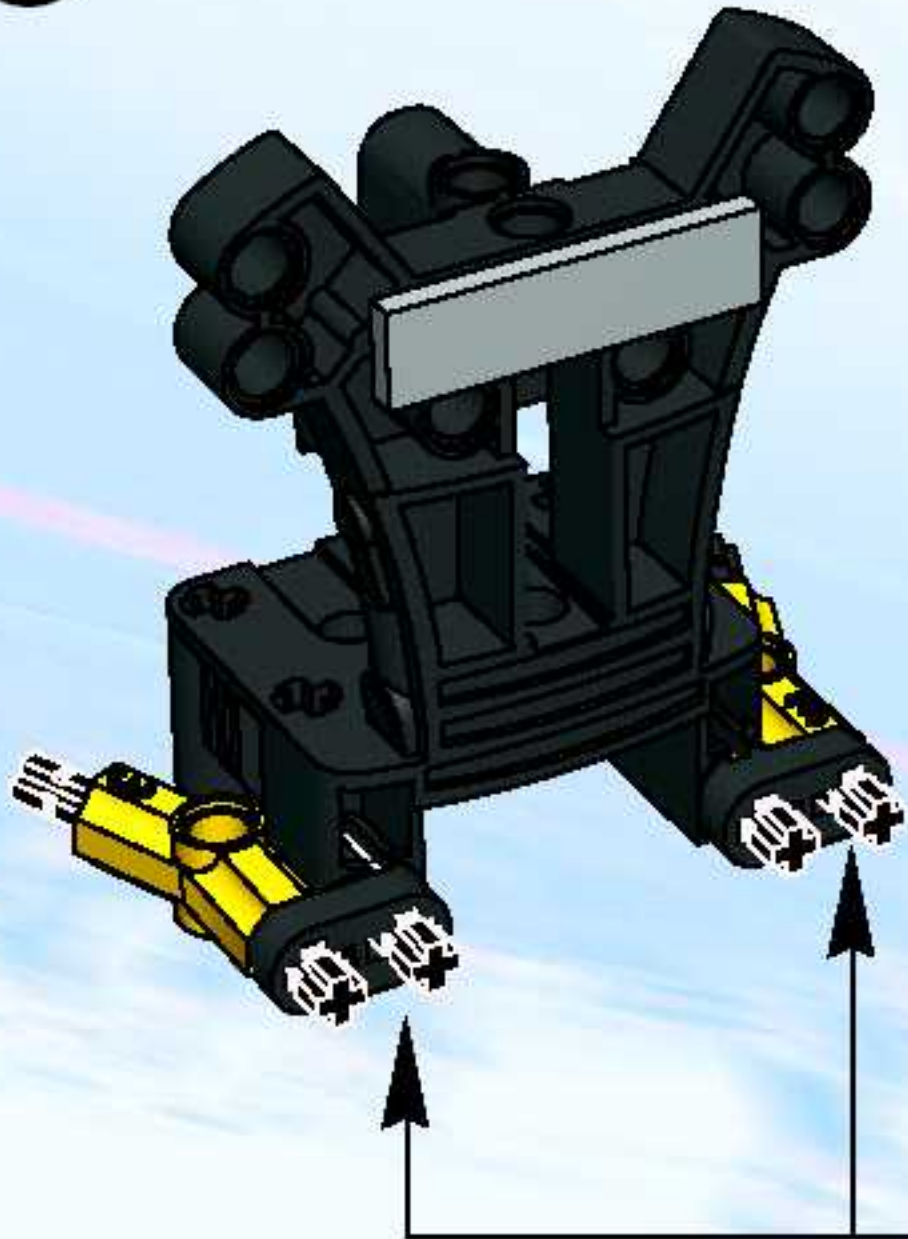

4

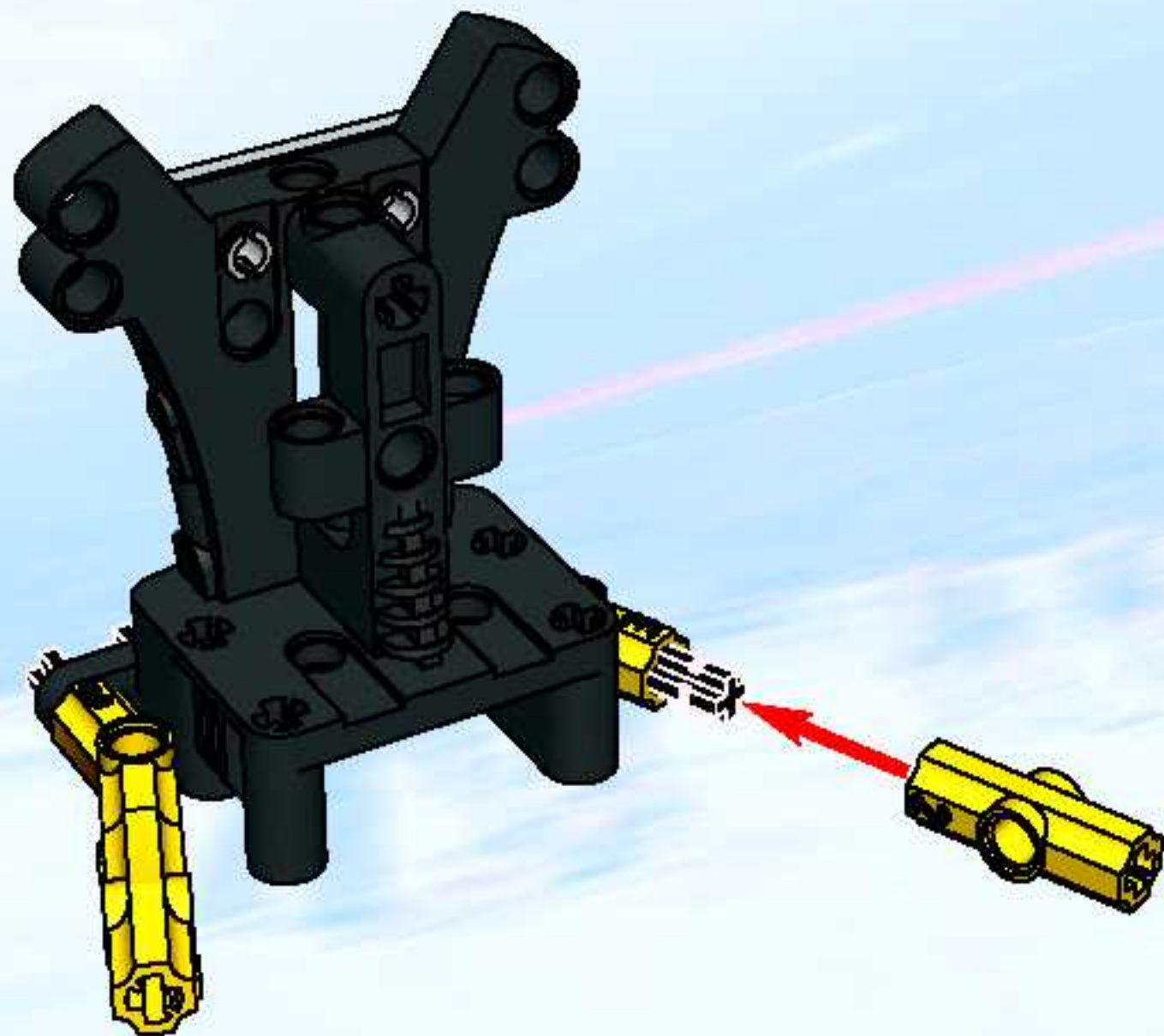

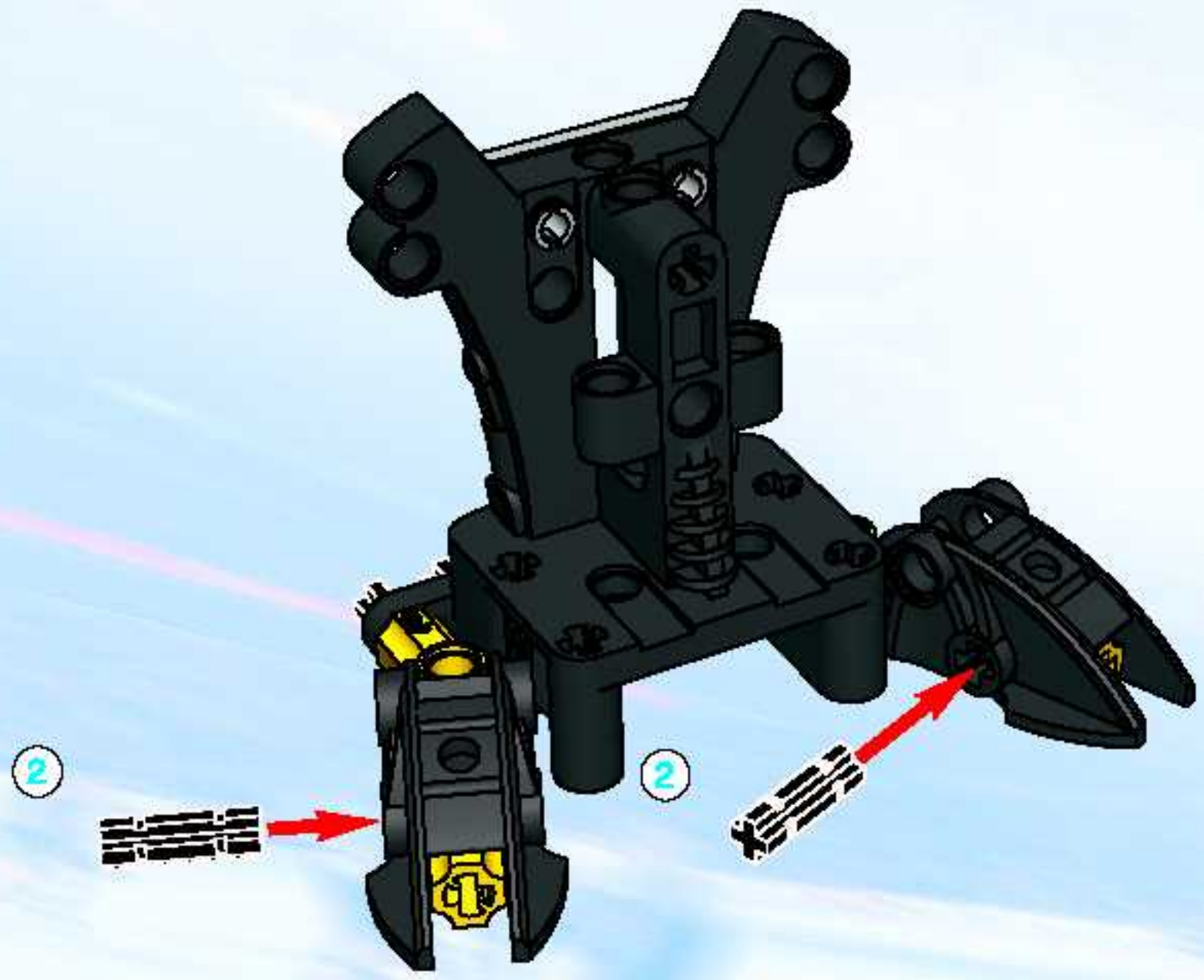

5



 2 1:1

6



  **1:1**

7



8

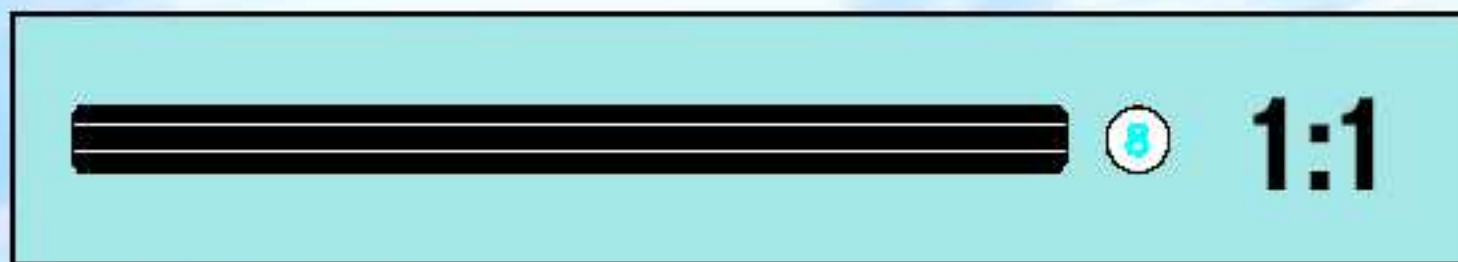
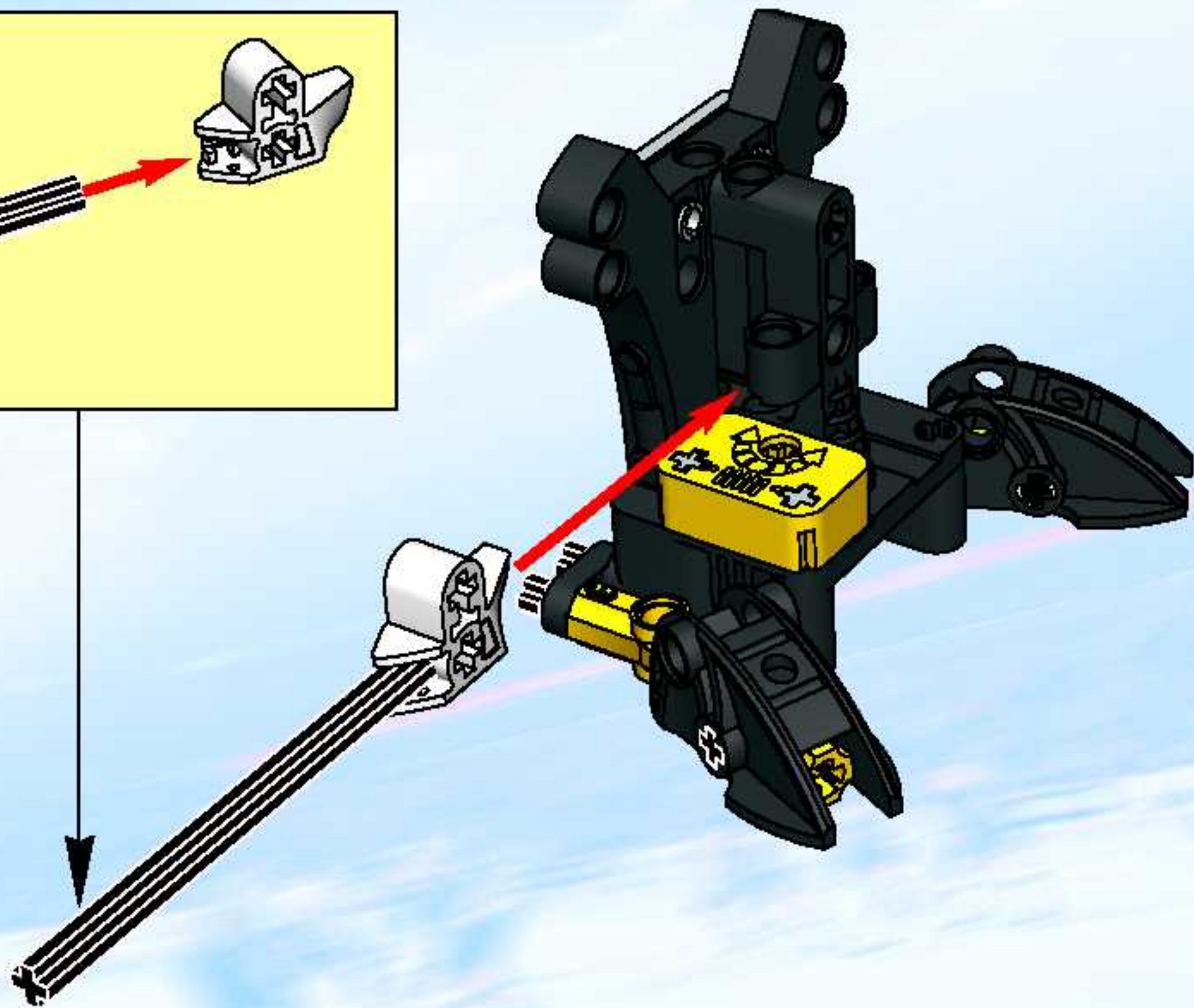
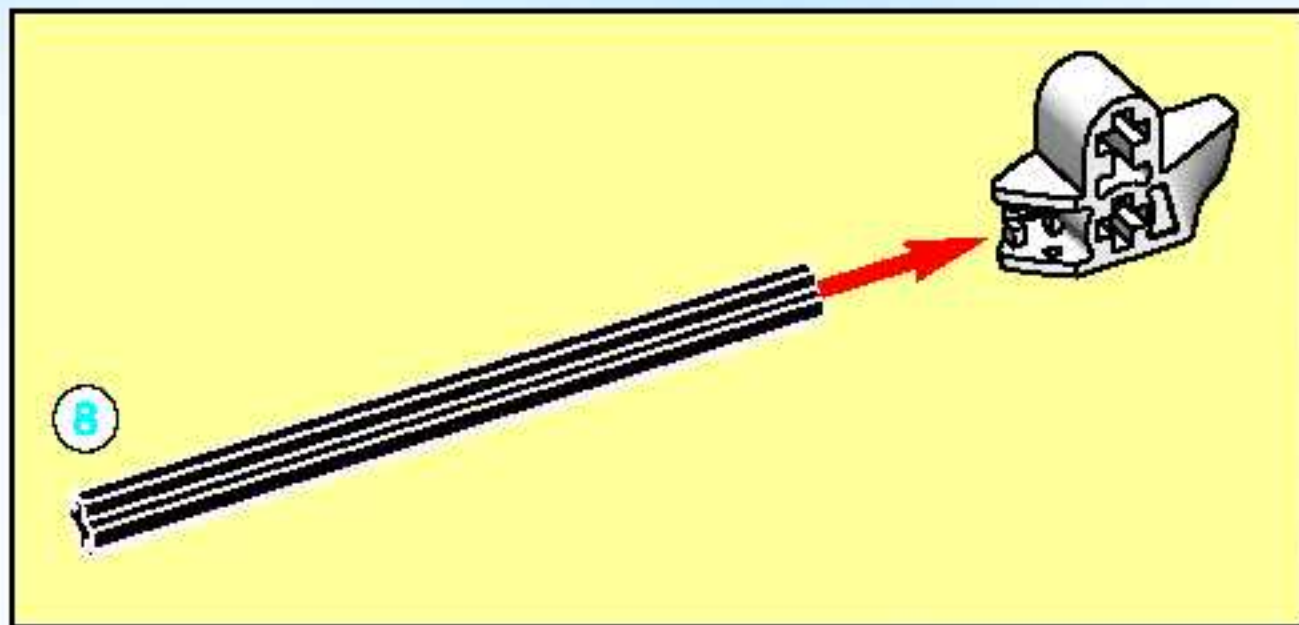

9



10



11

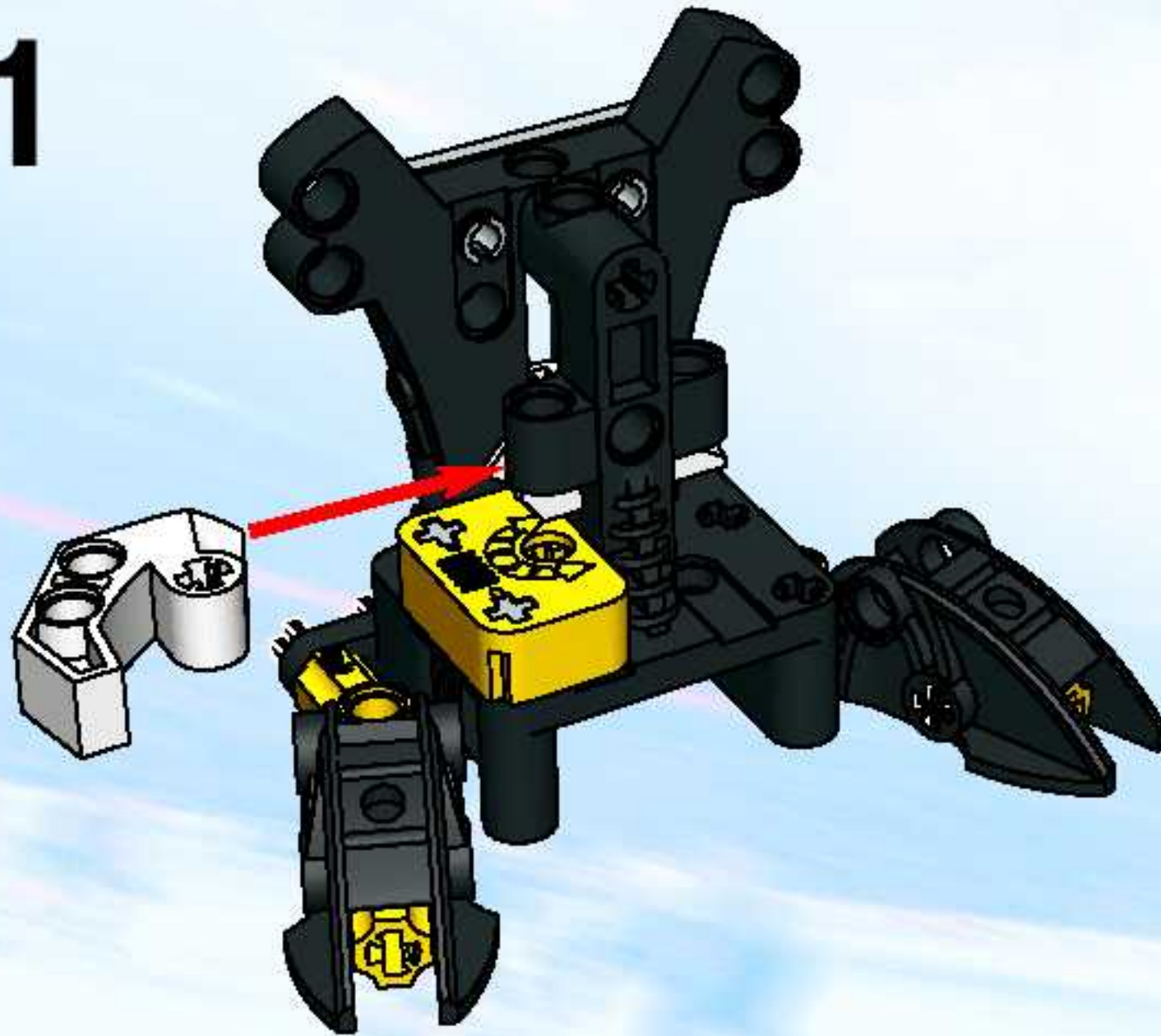

12

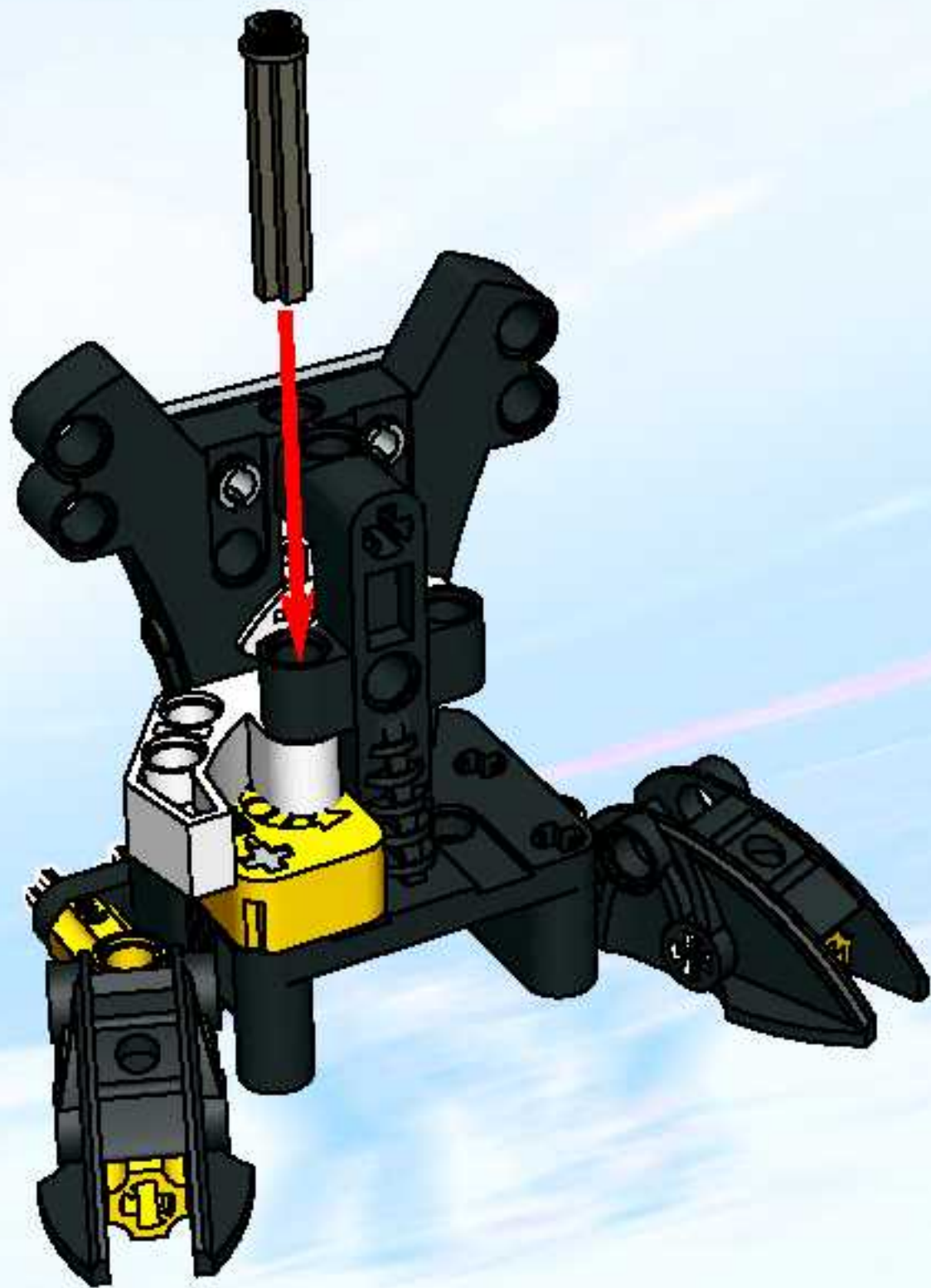

13



1

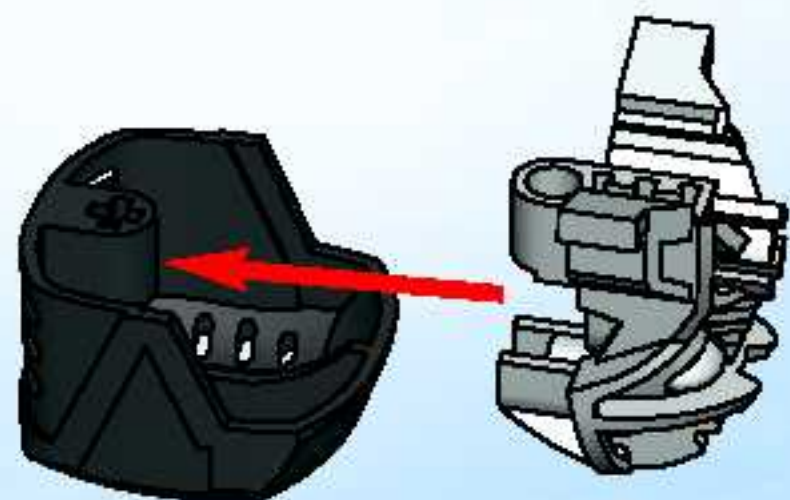

2

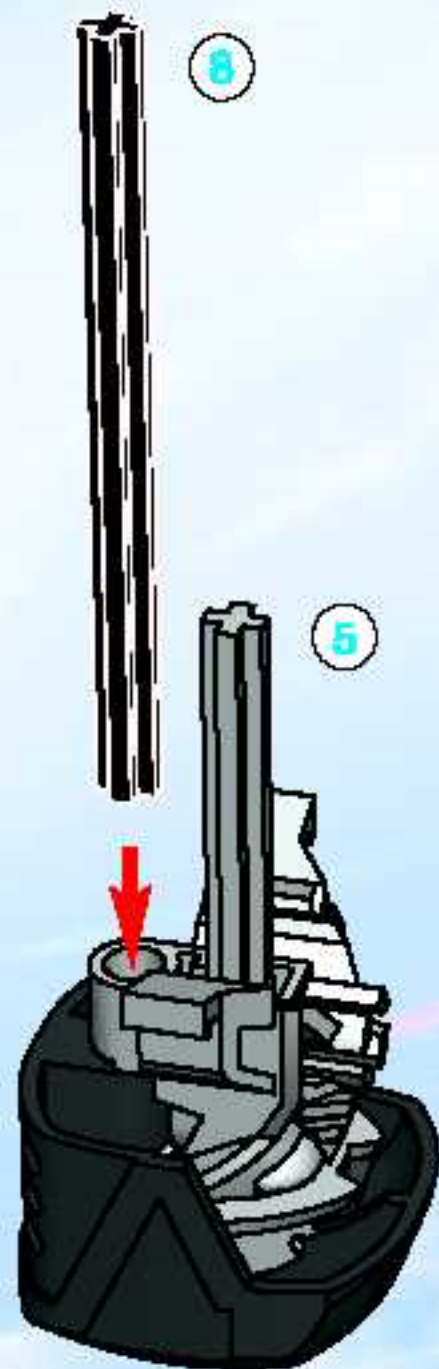

3

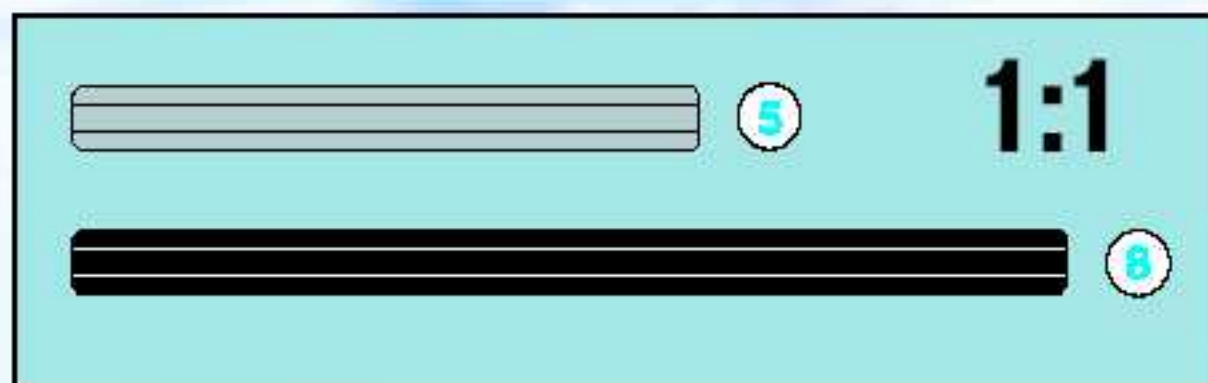
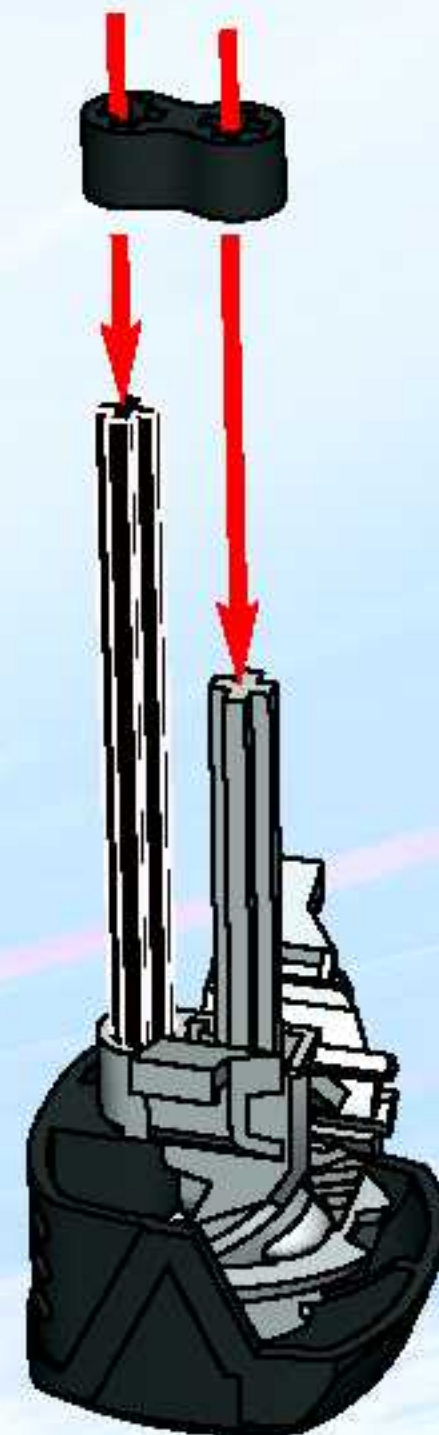

14

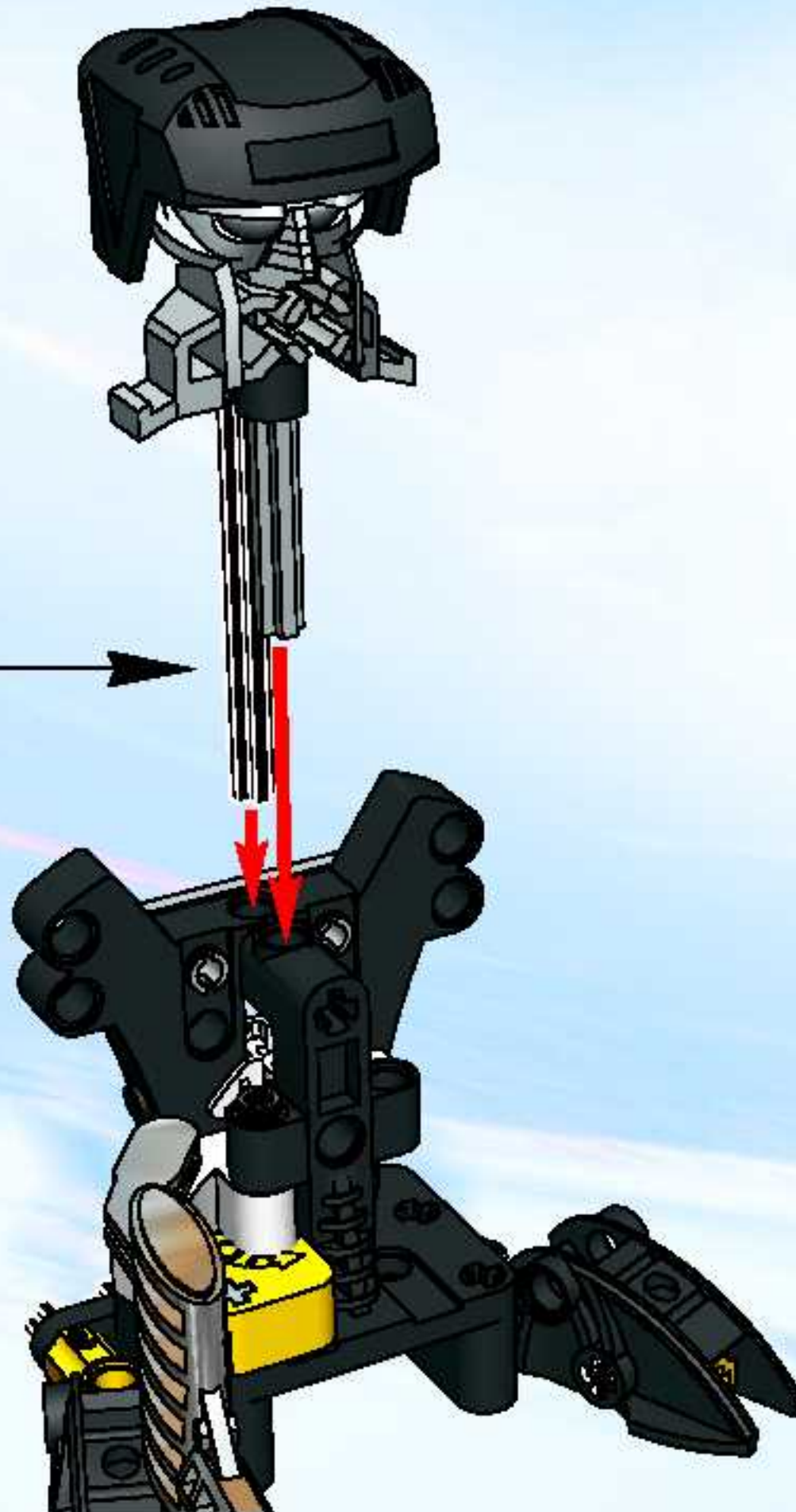

15

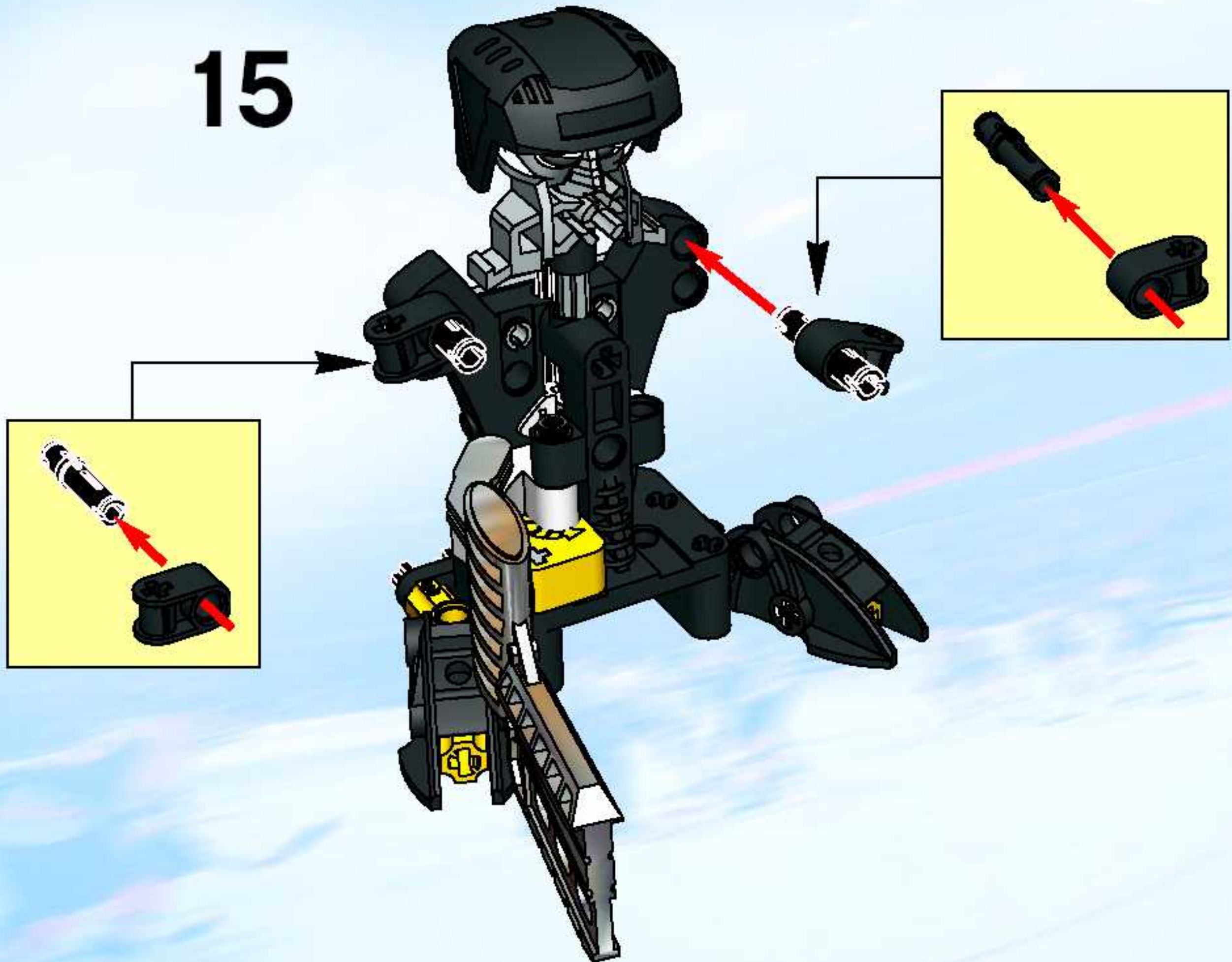

16



17



18

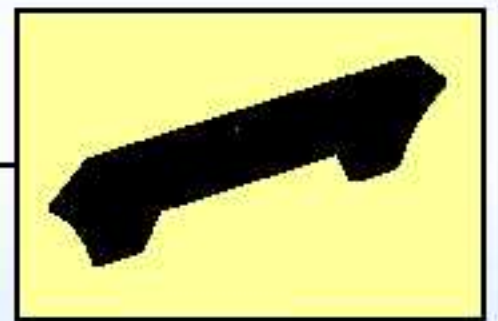
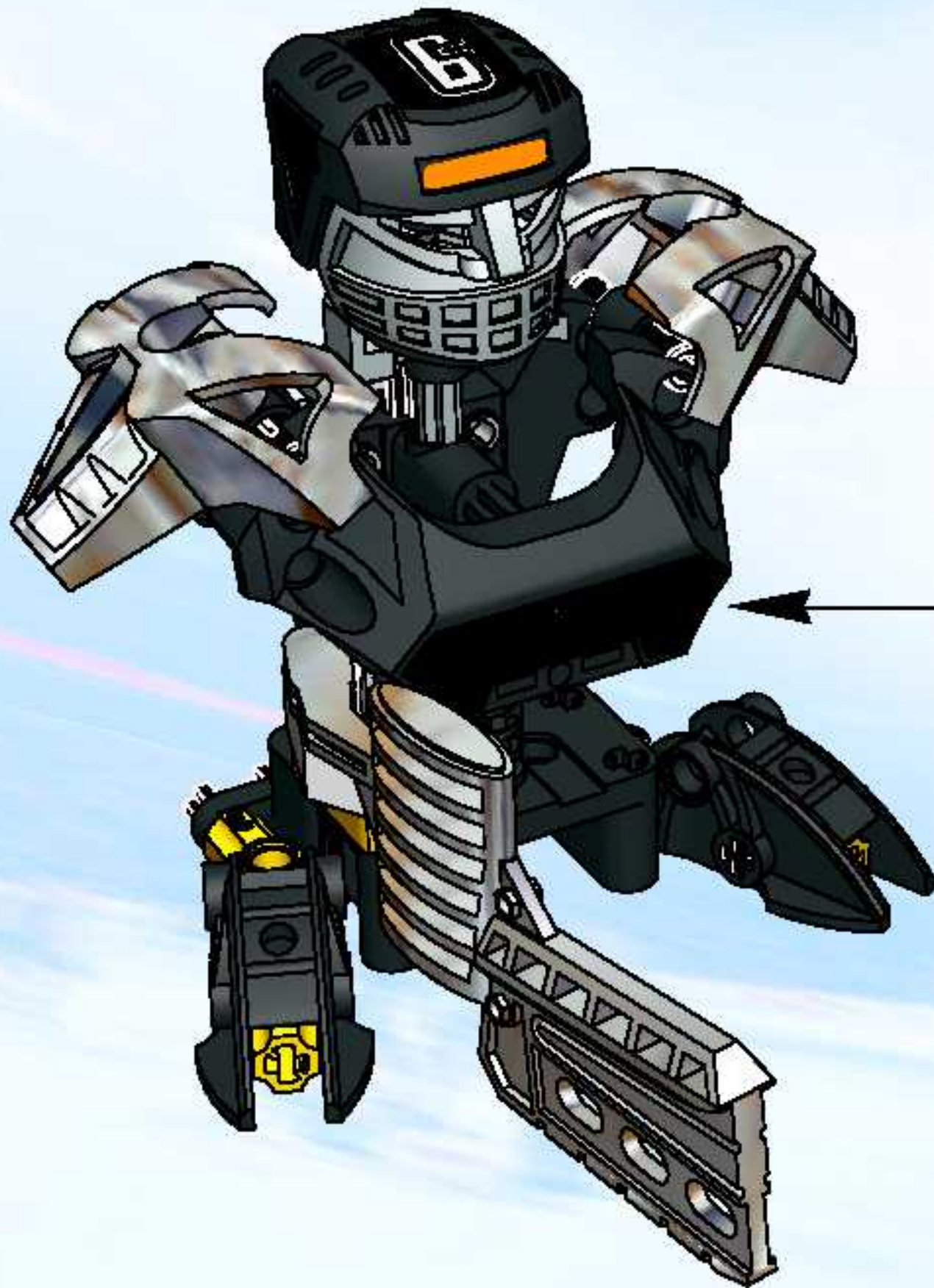

19



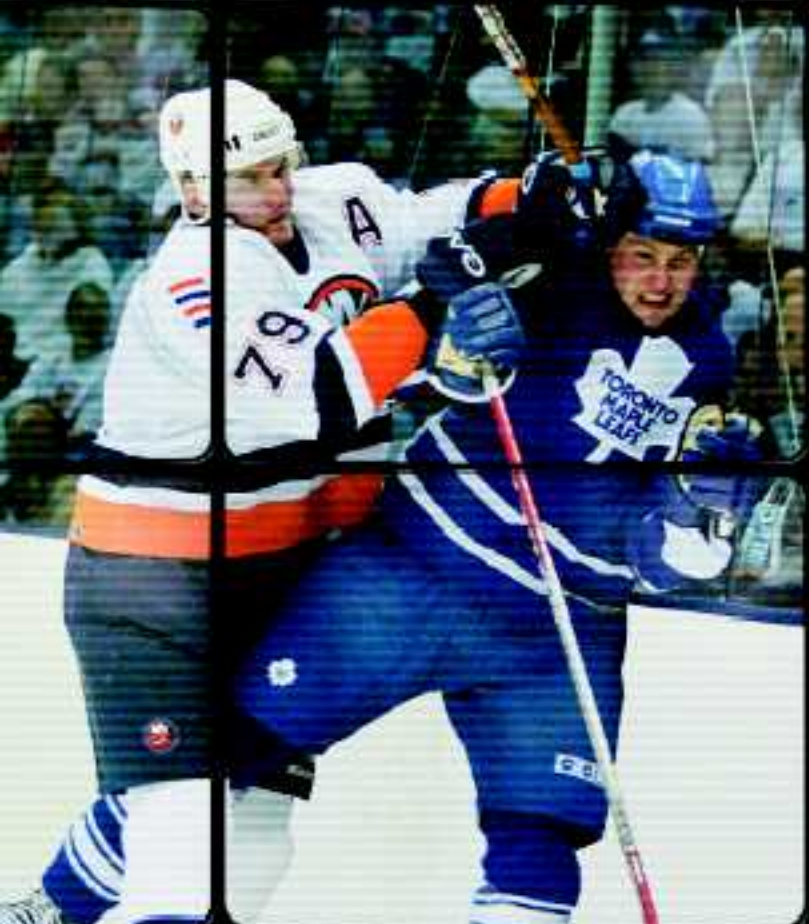

www.LEGO.com/sports

nhlpa
.COM



LEGO, the LEGO logo and the Minifigure are trademarks of the LEGO Group.
©2003 The LEGO Group.
NHL and the NHL Shield are registered trademarks of the National Hockey League. All NHL logos and marks and team logos and marks depicted herein are the property of the NHL and the respective teams and may not be reproduced without the prior written consent of NHL Enterprises, L.P. © NHL 2003. All Rights Reserved.
© NHLPA. NHLPA, National Hockey League Players' Association and the NHLPA logo are trademarks of the NHLPA.

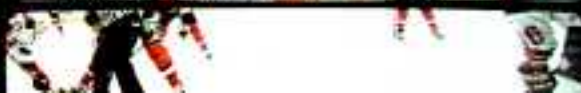

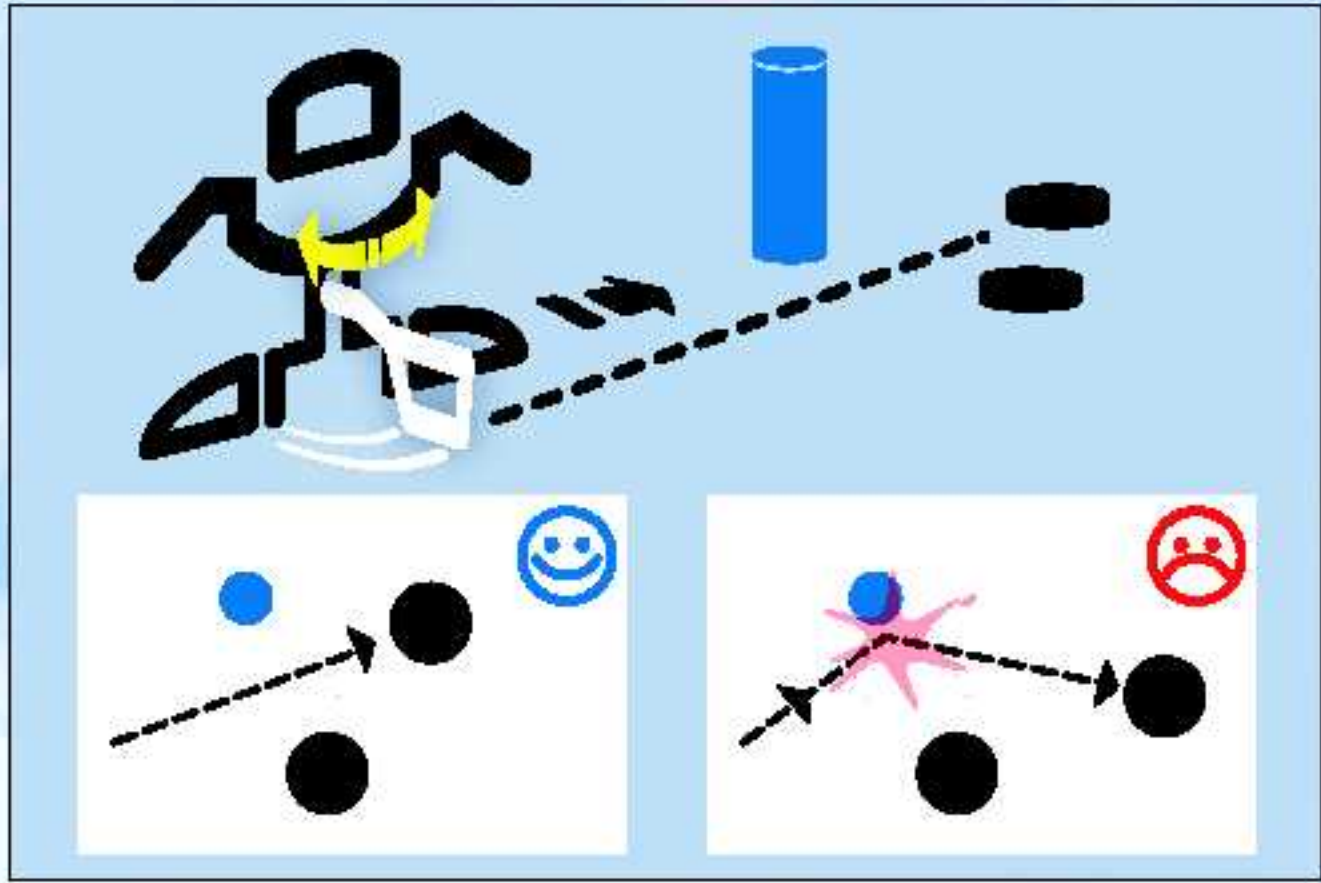
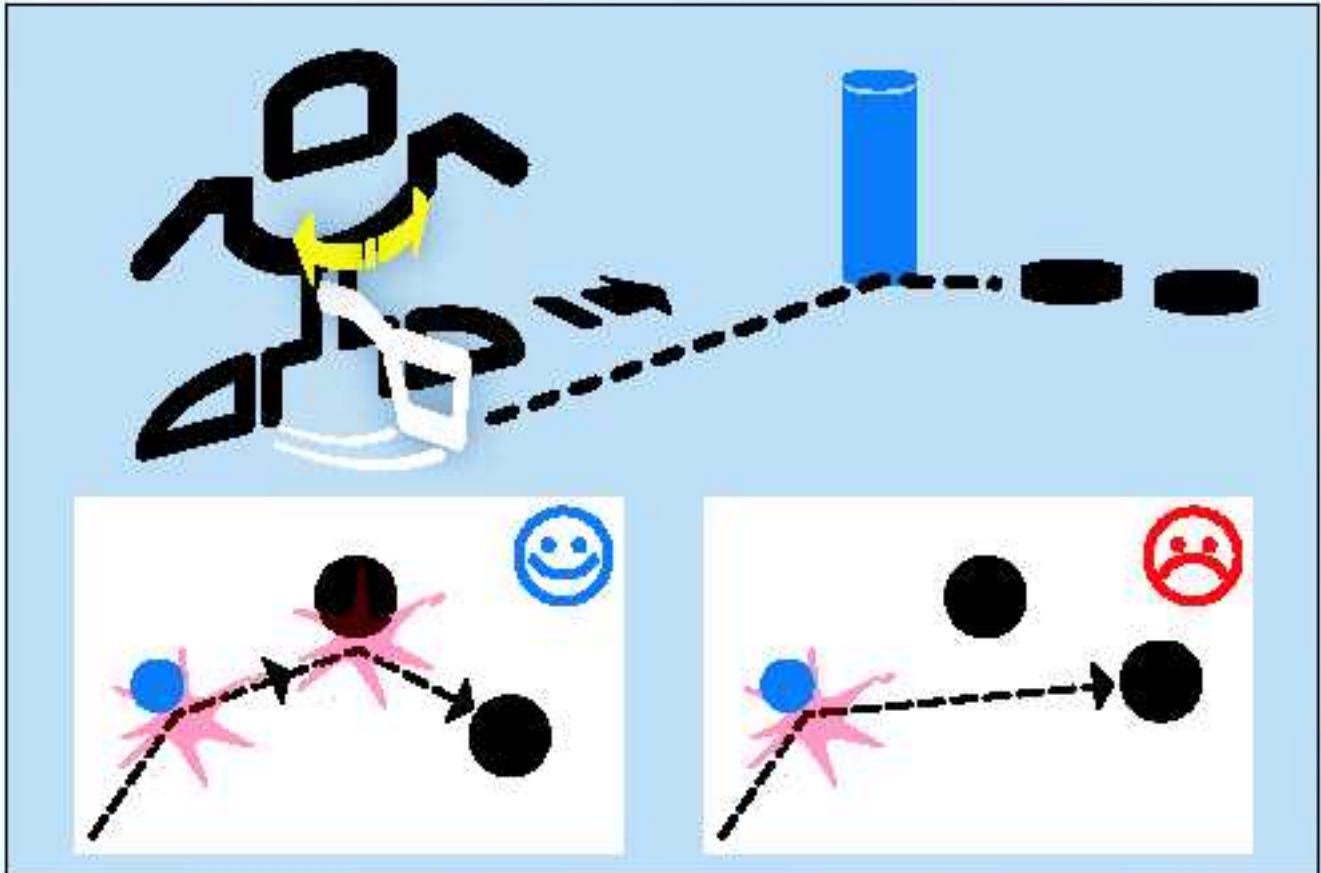





3428



3429



3433





3535



3537



3538



3585



3536



BG: Почерете рпеји yHOTpeдa

LT: Prieš naudojimą nuvalyti

ET: Enne tarvitamist puhastada

LV: Pirms lietošanas jānotīra

TR: Kullamadan önce temizleyin



KO: 김모범으로 빡뮌어A7 권이 깨끗0 씻어주세요

RU: Перед использованием очищать

PL: Wyczyścić przed użyciem

CS: Před použitím omyjte vodou.

SK: Před použitím umyte vodou.

HU: Használat előtt tisztítsd meg!

UA: Перед використанням очистити

HR: Očistite prije uporabe

SR: Очистити пре употребе

SL: Pred uporabo očisti

RO: A se curăța înainte de utilizare



EN: Clean before use

DE: Bitte vor Gebrauch reinigen

FR: Nettoyer avant usage

IT: Pulire prima dell'uso

NL: Vóór gebruik reinigen

ES: Limpiar antes de usar

DA: Rengøres før brug

FI: Puhdistaa ennen käyttöä

SV: Rengör innan användning

PT: Limpar antes da utilização

EL: Καθαρίστε πριν τη χρήση

JP: 汚れを落とすことから使用してください。

LEGO **SPORTS**



NBA identifications depicted are the exclusive property of NBA Properties, Inc. and/or the NBA Member Teams, and are used with permission.

SPALDING is a trademark of Spalding Sports Worldwide, Inc. or Lisco Sports, Inc., a Spalding affiliate.
© Spalding Sports Worldwide, Inc. 2003.



WWW.LEGO.COM/sports

LEGO, the LEGO logo and the Minifigure are trademarks of the LEGO Group. ©2003 The LEGO Group.

adidas, the adidas logo and the three stripe trademark are registered trademarks of the adidas-Salomon group, used with permission. Fevernova and the Trigon logo are trademarks of the adidas-Salomon group, used with permission.

NHL and the NHL Shield are registered trademarks of the National Hockey League. All NHL logos and marks and team logos and marks depicted herein are the property of the NHL and the respective teams and may not be reproduced without the prior written consent of NHL Enterprises, L.P. © NHL 2003. All Rights Reserved.